

S = 1 : 250

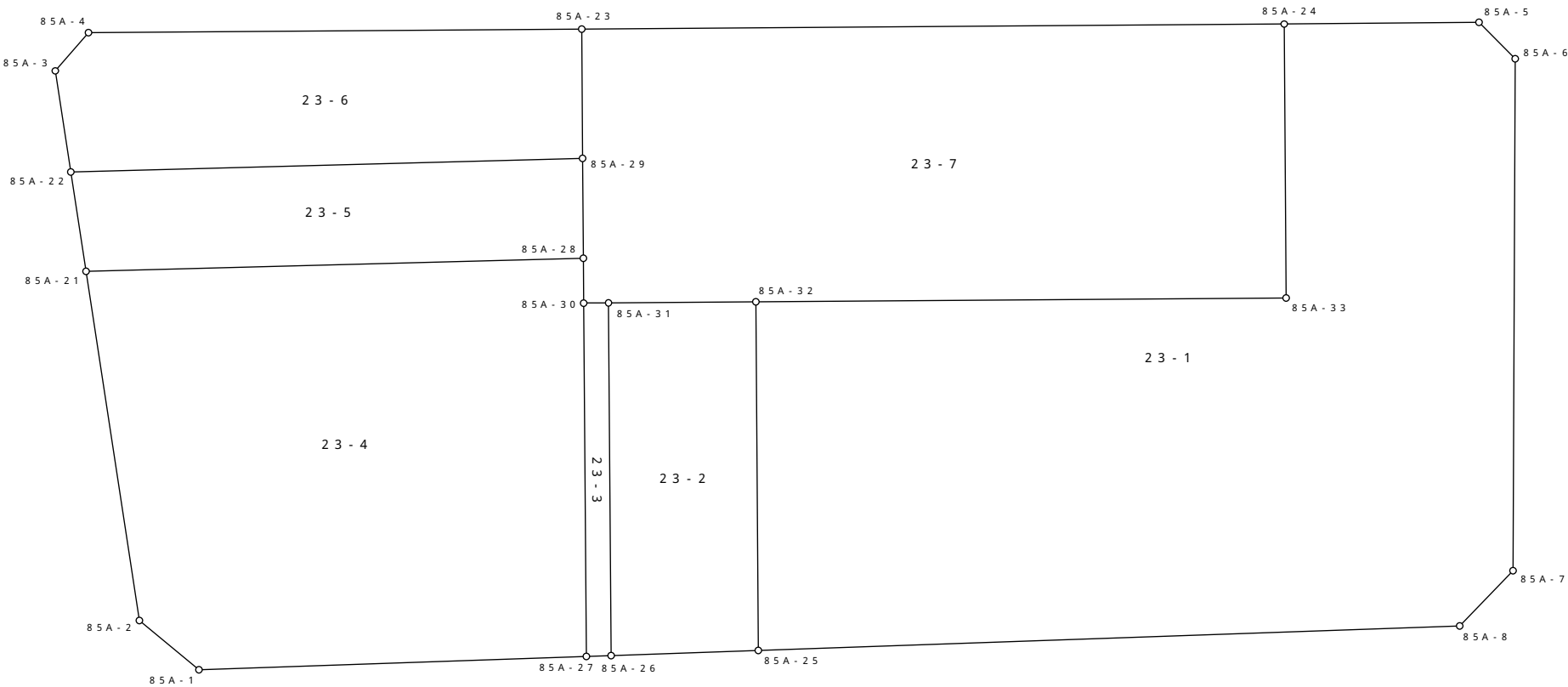

**参考資料**  
※記載内容は換地処分当時のものです。 上尾市

面積（座標法）計算書

地番 = 23-1  
測点名

	[1] X(i)	[2] X(i+1)-X(i-1)	[3] Y(i)	[4] Y(i+1)-Y(i-1)	[2]*[3]	[1]*[4]	方向角	夾 角	距 離
85A-25	-3895.258	30.126	-22813.715	0.833	-687285.978090	-3244.749914	66-26-35	88-24-52	13.559
85A-32	-3889.839	-13.493	-22801.286	20.671	307657.751998	-80406.861969	156-27-07	89-59-28	20.630
85A-33	-3908.751	-14.653	-22793.044	18.007	333986.473732	-70384.879257	66-26-08	270-00-59	10.653
85A-24	-3904.492	-2.686	-22783.279	12.806	61195.887394	-50000.924552	156-21-10	90-04-58	7.582
85A-5	-3911.437	-8.797	-22780.238	2.290	200397.753686	-8957.190730	202-04-23	134-16-47	1.998
85A-6	-3913.289	-9.595	-22780.989	-19.086	218583.589455	74689.033854	247-06-19	134-58-04	19.903
85A-7	-3921.032	-6.676	-22799.324	-21.130	152208.287024	82851.406160	290-53-40	136-12-39	2.992
85A-8	-3919.965	25.774	-22802.119	-14.391	-587701.815106	56412.216315	334-51-27	136-02-13	27.293
合計				倍面積	-958.049907	958.049907			104.610
				面 積	479.02	479.02			

面積（座標法）計算書

地番 = 23-2  
測点名

	[1] X(i)	[2] X(i+1)-X(i-1)	[3] Y(i)	[4] Y(i+1)-Y(i-1)	[2]*[3]	[1]*[4]	方向角	夾 角	距 離
85A-26	-3890.069	10.672	-22816.151	10.137	-243493.963472	-39433.629453	66-26-18	88-24-49	13.717
85A-31	-3884.586	0.230	-22803.578	14.865	-5244.822940	-57744.370890	156-25-38	90-00-40	5.731
85A-32	-3889.839	-10.672	-22801.286	-10.137	243335.324192	39431.297943	246-26-35	89-59-03	13.559
85A-25	-3895.258	-0.230	-22813.715	-14.865	5247.154450	57903.010170	334-51-07	91-35-28	5.732
合計				倍面積	-156.307770	156.307770			38.739
				面 積	78.15	78.15			

面積（座標法）計算書

地番 = 23-3  
測点名

	[1] X(i)	[2] X(i+1)-X(i-1)	[3] Y(i)	[4] Y(i+1)-Y(i-1)	[2]*[3]	[1]*[4]	方向角	夾 角	距 離
85A-27	-3889.196	6.368	-22816.560	12.187	-145295.854080	-47397.631652	66-25-51	88-27-58	13.742
85A-30	-3883.701	4.610	-22803.964	12.982	-105126.274040	-50418.206382	156-26-07	89-59-44	0.966
85A-31	-3884.586	-6.368	-22803.578	-12.187	145213.184704	47341.449582	246-26-18	89-59-49	13.717
85A-26	-3890.069	-4.610	-22816.151	-12.982	105182.456110	50500.875758	334-53-49	91-32-29	0.964
合計				倍面積	-26.487306	26.487306			29.389
				面 積	13.24	13.24			

面積（座標法）計算書

地番 = 23-4  
測点名

	[1] X(i)	[2] X(i+1)-X(i-1)	[3] Y(i)	[4] Y(i+1)-Y(i-1)	[2]*[3]	[1]*[4]	方向角	夾 角	距 離
85A-1	-3875.543	16.539	-22822.959	-5.543	-377468.918901	21482.134849	16-31-14	138-22-03	3.010
85A-2	-3872.657	10.127	-22822.103	12.519	-231119.437081	-48481.792983	58-09-57	138-21-17	13.728
85A-21	-3865.416	-10.348	-22810.440	19.734	236042.433120	-76280.119344	155-21-04	82-48-53	19.352
85A-28	-3883.005	-18.285	-22802.369	6.476	416941.317165	-25146.340380	246-25-31	88-55-33	1.740
85A-30	-3883.701	-6.191	-22803.964	-14.191	141179.341124	55113.600891	246-25-51	179-59-40	13.742
85A-27	-3889.196	8.158	-22816.560	-18.995	-186137.496480	73875.278020	334-53-17	91-32-34	15.078
合計				倍面積	-562.761053	562.761053			66.650
				面 積	281.38	281.38			

面積（座標法）計算書

地番 = 23-5  
測点名

	[1] X(i)	[2] X(i+1)-X(i-1)	[3] Y(i)	[4] Y(i+1)-Y(i-1)	[2]*[3]	[1]*[4]	方向角	夾 角	距 離
85A-21	-3865.416	19.656	-22810.440	-4.748	-448362.008640	18352.995168	58-07-02	97-14-02	3.913
85A-22	-3863.349	-16.036	-22807.117	11.633	365734.928212	-44942.338917	155-20-35	82-46-27	19.919
85A-29	-3881.452	-19.656	-22798.807	4.748	448133.350392	-18429.134096	246-26-36	88-53-59	3.886
85A-28	-3883.005	16.036	-22802.369	-11.633	-365658.789284	45170.997165	335-21-04	91-05-32	19.352
合計				倍面積	-152.519320	152.519320			47.070
				面 積	76.25	76.25			

面積（座標法）計算書

地番 = 23-6  
測点名

	[1] X(i)	[2] X(i+1)-X(i-1)	[3] Y(i)	[4] Y(i+1)-Y(i-1)	[2]*[3]	[1]*[4]	方向角	夾 角	距 離
85A-22	-3863.349	20.201	-22807.117	-4.933	-460726.570517	19057.900617	58-08-56	97-11-39	3.976
85A-3	-3861.251	1.495	-22803.740	5.253	-34091.591300	-20283.151503	107-49-08	130-19-48	1.971
85A-4	-3861.854	-18.189	-22801.864	9.544	414743.104296	-36857.534576	156-26-29	131-22-39	19.185
85A-23	-3879.440	-19.598	-22794.196	3.057	446720.653208	-11859.448080	246-25-34	90-00-55	5.031
85A-29	-3881.452	16.091	-22798.807	-12.921	-366855.603437	50152.241292	335-20-35	91-04-59	19.919
合計				倍面積	-210.007750	210.007750			50.082
				面 積	105.00	105.00			

面積（座標法）計算書

地番 = 23-7  
測点名

	[1] X(i)	[2] X(i+1)-X(i-1)	[3] Y(i)	[4] Y(i+1)-Y(i-1)	[2]*[3]	[1]*[4]	方向角	夾 角	距 離
85A-23	-3879.440	-23.040	-22794.196	15.528	525178.275840	-60239.944320	156-27-13	89-58-21	27.327
85A-24	-3904.492	-29.311	-22783.279	1.152	667800.690769	-4497.974784	246-26-08	90-01-05	10.653
85A-33	-3908.751	14.653	-22793.044	-18.007	-333986.473732	70384.879257	336-27-07	89-59-01	20.630
85A-32	-3889.839	24.165	-22801.286	-10.534	-550993.076190	40975.564026	336-25-38	180-01-29	5.731
85A-31	-3884.586	6.138	-22803.578	-2.678	-139968.361764	10402.921308	336-26-07	179-59-31	0.966
85A-30	-3883.701	1.581	-22803.964	1.209	-36053.067084	-4695.394509	66-25-31	90-00-36	1.740
85A-28	-3883.005	2.249	-22802.369	5.157	-51282.527881	-20024.656785	66-26-36	179-58-55	3.886
85A-29	-3881.452	3.565	-22798.807	8.173	-81277.746955	-31723.107196	66-25-34	180-01-02	5.031
合計				倍面積	-582.286997	582.286997			75.964
				面 積	291.14	291.14			